



2" Type 'B' RESET RELIEF VALVE

O'Drill's Reset Relief Valve is completely interchangeable with Cameron & Retsco type 'B' and 'C', 2" & 3" Reset Relief Valves. The O'Drill type 'B' reset relief valve is used as a safety valve on slush pumps and mud manifolds to protect against damaging pressure surges.

Hydraulic use: 1500 -6200 PSI W.P.
Gas Use: 1500 - 2500 PSI W.P.

*Top Quality...
Lowest Prices...
Guaranteed!!!*



2"

2" PART NUMBER 30400

Complete Valve PIN	Pressure Range
30400-3	400 - 1500 PSI
30400-1	750 - 2500 PSI
30400-2	1500 - 5000 PSI
30400-4	1500 - 6200 PSI
30418	Bonnet Assy.

PARTS LIST

#	QTY.	DESCRIPTION	PART NO.
1	1	Nut, Elastic Stop	5953-34
2	1	Stud, Adjusting	20798
3	2	Pin, Spirol 1/4" x 1 1/2"	20712-04
4	1	Retainer, Upper Spring	30385
5	1	Indicator	30379
6	12	Screw, Self Tap	2975-03
7	8	Screw, Socket-Head Cap	204044-10-00-14
8	1	Plate, Name	30170
9	1	Assy. Cover	38159
10	1	Screw, Load	30389
11	1	Plate, Calibration	21048
12	1	O-Ring	6227-15-01-70
13	1	Handle, Reset	30377
14	1	Pin Spirol 5/16" x 1 3/8"	20712-13
15	1	Pin, Crank Pivot	30381
16	2	Spring, Reset	20791
17	2	Bearing, Crank Assy.	13229-13
18	1	Crank Assy.	38161
19	1	Pin Spirol 1/8" x 7/8"	20712-03
20	1	Pin, Top Crank	20802
21	1	Button, Release	30396
22	1	Spring, Button Release	30390
23	1	Shaft Release	30397
24	1	Bushing, Release Button	30368
25	1	Roller, Reset Crank	30388
26	7	Pin Spirol 1/8" x 5/8"	20712-02
27	1	Crank, Reset	30373
28	1	Rod, Spring Guide	30387
29	1	Keeper, Spring	30380
30	1	Spring, Reset Crank	30391
31	2	Spring, Load	20805-01
32	1	Retainer, Lower Spring	30382
33	1	Fitting, Grease	5929-02
34	1	Sub Assy. Bonnet	38160
35	1	Plate, Instruction	30178
36	1	Bushing, Stem	30369
37	1	Body	20780
38	1	Link, Upper	20787
39	2	Link, Lower	20786
40	2	Pin, Lower	23545
41	1	Ring, Cushion	20795
42	1	Piston	20784
45	1	Retainer, Outer	20788
46	1	Gasket	20790
47	1	Outer Seal	21792-15
48	1	Sub	20793
49	1	Plug, Grease	20750
50	2	Bearing, bonnet	13229-08
51	1	Bearing, cover	13229-12
52	1	Bearing, Upper link	13229-14
53	1	Bearing, Piston	13229-10

★ All our valves come with:

- Complete DATA-BOOKS
- Material Certification & Traceability.
- DNV Type approval available
- Good for H2S Service.

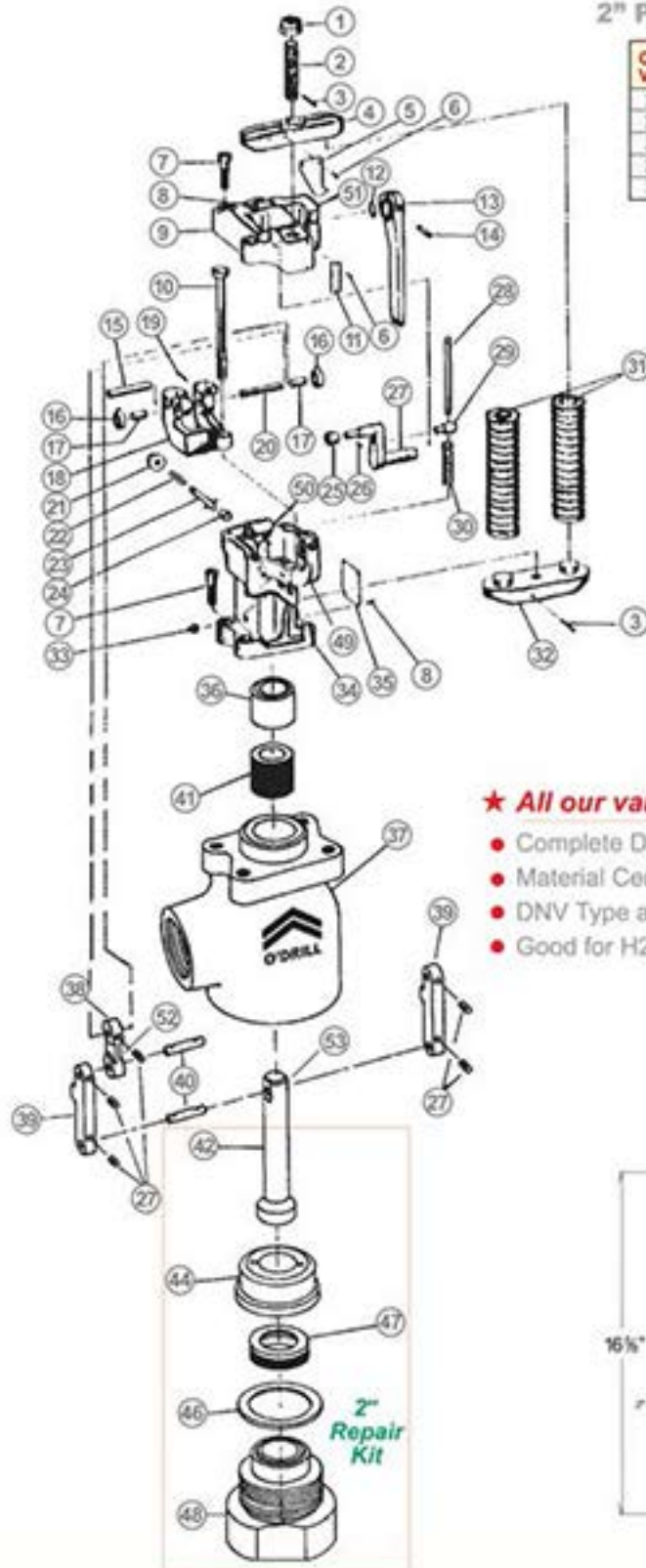

* Note: # 43 & 44 Intentionally left out.

2 Check out our Quality.....Compare our Prices!!! Call... (713) 541-2020

3" Type 'B' RESET RELIEF VALVE

The 3" Type 'B' O'Drill Reset Relief Valve is built to provide accurate and reliable protection from extreme pressures. The valve is designed primarily for drilling mud use, but it works equally well on any liquid or gas. The O'Drill Reset Relief Valve is fully enclosed for maximum protection of all moving parts and provides the following design features:

- Valve automatically snaps open to discharge dangerous pressures when maximum pressure setting is exceeded.
- Pressure rating can be changed by merely turning a nut.
- Pressure setting is indicated by pointer.
- Once the valve releases the pressure, it can be reset within seconds by moving the reset handle.
- Valve can be opened at any time by pressing the release button.
- The main parts such as the piston, are manufactured from 17-4 PH corrosive-resistant material and seals are made of Hycar, designed to be out of the direct path of flow, for extra long life.

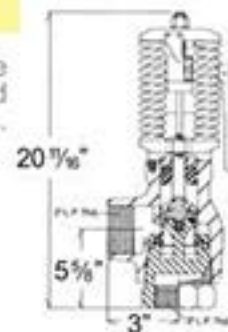

PARTS LIST

#	QTY.	DESCRIPTION	PART NO.
1	1	Nut, Elastic Stop	5953-34
2	1	Stud, Adjusting	20798
3	2	Pin, Spirol 1/4" x 1 1/2"	20712-04
4	1	Retainer, Upper Spring	30385
5	1	Indicator	30379
6	12	Screw, Self Tap	2975-03
7	8	Screw, Socket-Head Cap	204044-10-00-14
8	1	Plate, Name	30170
9	1	Assy. Cover	38159
10	1	Screw, Load	30380
11	1	Plate, Calibration	21048
12	1	O-Ring	6227-15-01-70
13	1	Handle, Reset	30377
14	1	Pin Spirol 5/16" x 1 3/8"	20712-13
15	1	Pin, Crank Pivot	30381
16	2	Spring, Reset	20791
17	2	Bearing, Crank Assy.	13229-13
18	1	Crank Assy.	38161
19	1	Pin Spirol 1/8" x 7/8"	20712-03
20	1	Pin, Top Crank	20802
21	1	Button, Release	30396
22	1	Spring, Button Release	30390
23	1	Shaft Release	30397
24	1	Bushing, Release Button	30368
25	1	Roller, Reset Crank	30388
26	7	Pin Spirol 1/8" x 5/8"	20712-02
27	1	Crank, Reset	30373
28	1	Rod, Spring Guide	30387
29	1	Keeper, Spring	30380
30	1	Spring, Reset Crank	30391
31	2	Spring, Load	20805-01
32	1	Retainer, Lower Spring	30382
33	1	Fitting, Grease	5929-02
34	1	Sub Assy. Bonnet	38160
35	1	Plate, Instruction	30178
36	1	Bushing, Stem	30828
37	1	Body	30822
38	1	Link, Upper	20787
39	2	Link, Lower	20786
40	2	Pin, Lower	23545
41	1	Ring, Cushion	30834
42	1	Piston	30829
43	1	Retainer, Inner	30826
44	1	Seal, Inner	30831
45	1	Retainer, Outer	30827
46	1	O-Ring	6230-21-13-85
47	1	Seal, Outer	30833
48	1	Sub	30824
49	1	Plug, Grease	20750
50	2	Bearing, bonnet	13229-08
51	1	Bearing, cover	13229-12
52	1	Bearing, Upper link	13229-14
53	1	Bearing, Piston	13229-10

Good for
H₂S
Service

3" PART NUMBER 30825

Complete Valve P/N	Pressure Range
30825-03	400 - 1500 PSI
30825-01	750 - 2500 PSI
30825-02	1500 - 5000 PSI
30825-04	1500 - 6200 PSI
30820	Bonnet Assy.

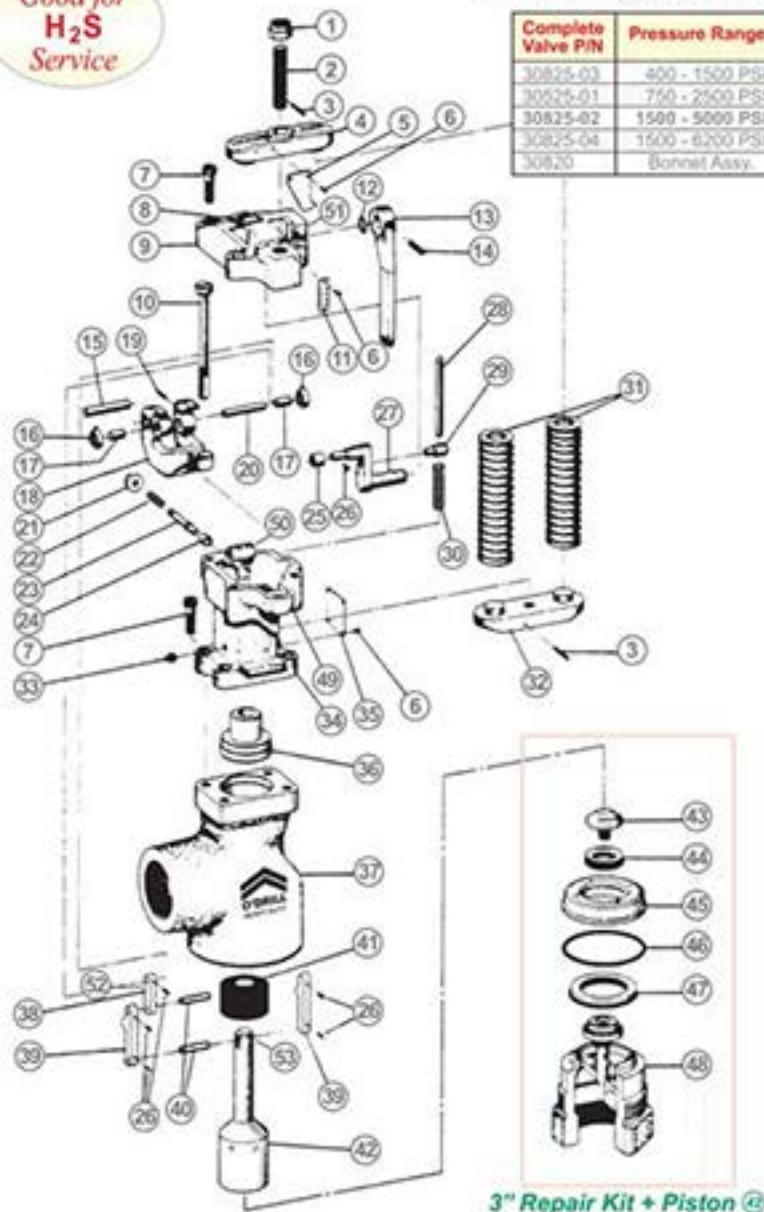

★ Valve Repair

O'Drill can rebuild your damaged Cameron & Retasco 2" and 3" Type 'B' and 'C' Reset Relief Valve to a brand new condition for a very nominal price.